

GARANZIA  
WARRANTY  
GARANTIE

5

ANNI  
YEARS  
ANS - JAHRE



***igi* DOMINO**

Mod. S.P. 602 cal. .22 l.r.

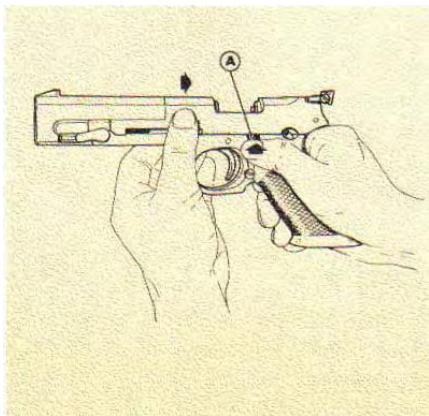

- 1)  
Take the car and push in the direction indicated by the arrow, press A to block it

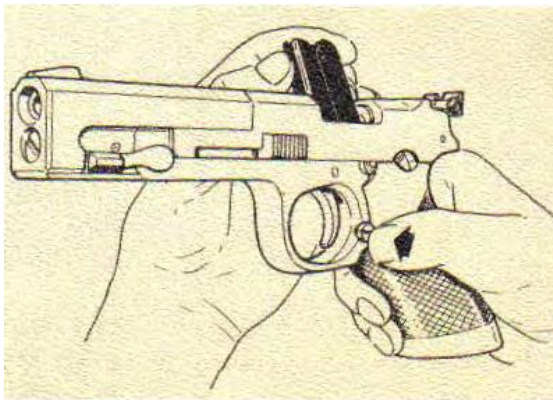

- 2)  
Press the button that indicates the arrow and pull the magazine. Push the car back to release it leaving it to return to the locked position

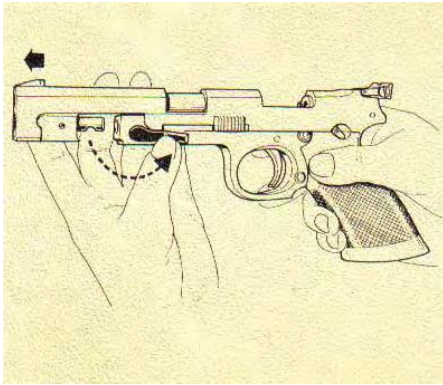

- 3)  
Turn 180° (counterclockwise)  
the locking lever and remove  
the counterweight forward

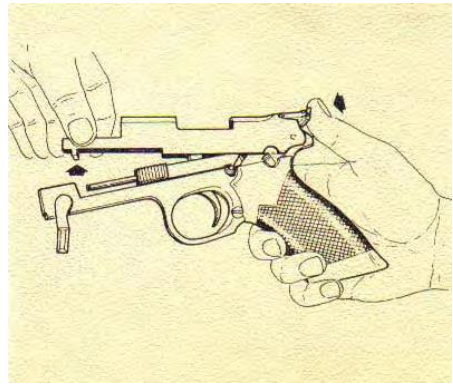

- 4)  
Push and raise the carriage  
cover to remove it

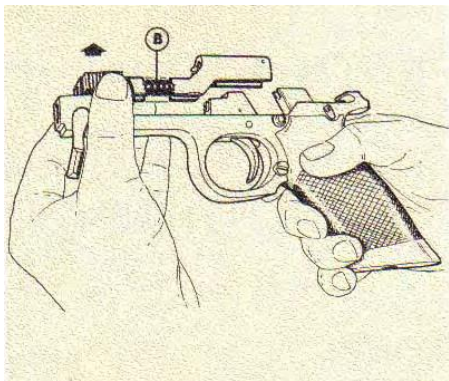

- 5)  
Raise the carriage of your seat  
releasing the spring guide B

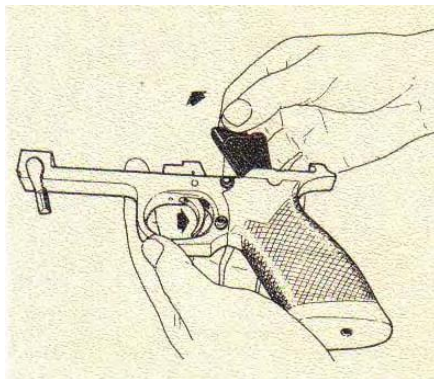

- 6)  
Remove the retaining nut and  
pull the cassette upwards  
simultaneously pressing the  
trigger

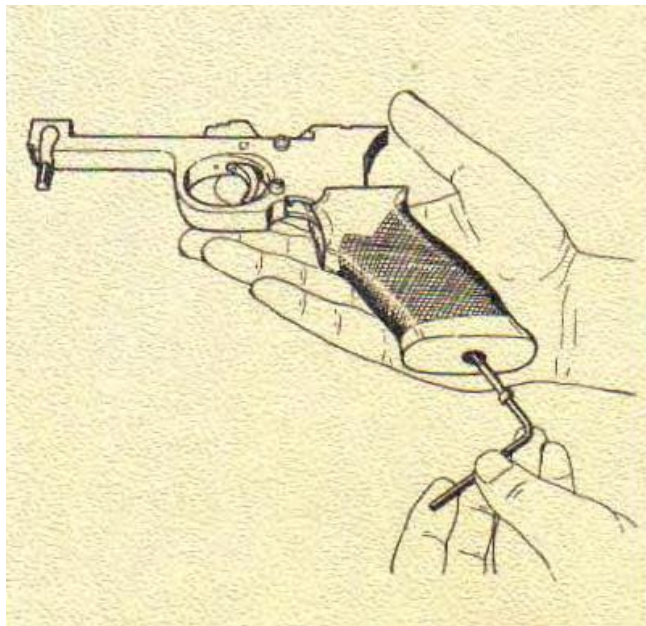

7)  
Using the appropriate  
unscrew key the screw  
that fixes the handle

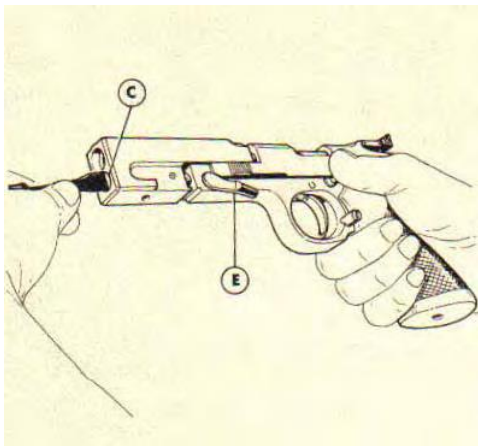

10)

A) Periodically track the locking of the weapon locking lever (E)

If the lever is not sufficiently locked, proceed

as follows: turn the lever (E)  $180^\circ$  counterclockwise to tighten the screw (C)  $20^\circ$  clockwise and turn  $180^\circ$  in a clockwise direction the lever (E) check that the lever is locked sufficiently if it is not so to repeat successively.

(The lever is sufficiently locked when after several shots it does not move low) It is convenient to check the rear shock absorber Located on the truck cover and the screws That fix the cassette and the trigger Clean the gun and the charger with great care avoiding the use of solvent oils



## ADJUSTMENTS

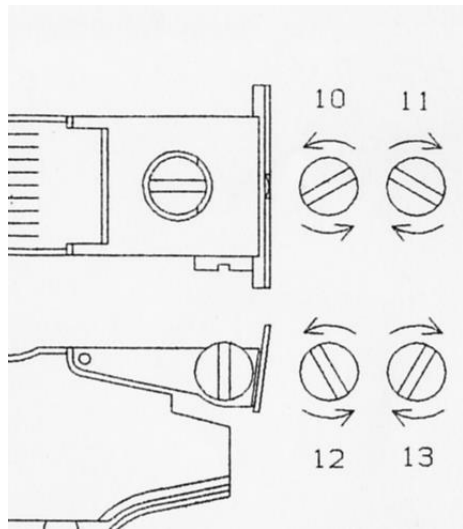

1)  
To raise the shot fig N°10, to lower  
the shot fig N°11

2)  
To correct shot to the left fig. 12, to  
correct shot to the right fig. 13

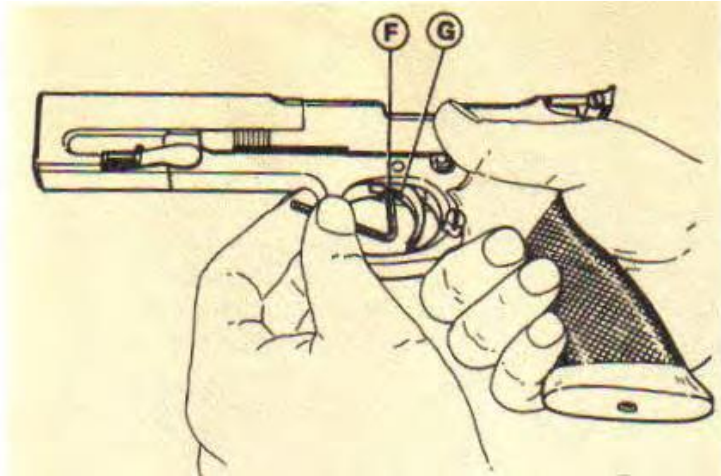

3)

Adjustment of the dead travel of the screw trigger F Turning clockwise reduces the travel (do not completely remove it since it will not engage the trigger)

4)

Adjusting the weight of the first time screw G turning clockwise increases the weight



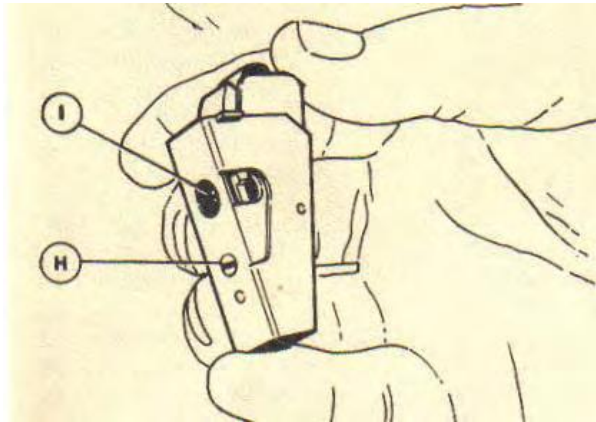

5)  
Fine adjustment of the second time screw I turn the screw 5 by 5 ° for the adjustment turn clockwise it is reduced second time

6)  
Adjusting the weight of the second time screw H turn clockwise it increases pressure one full turn is equal to 100g

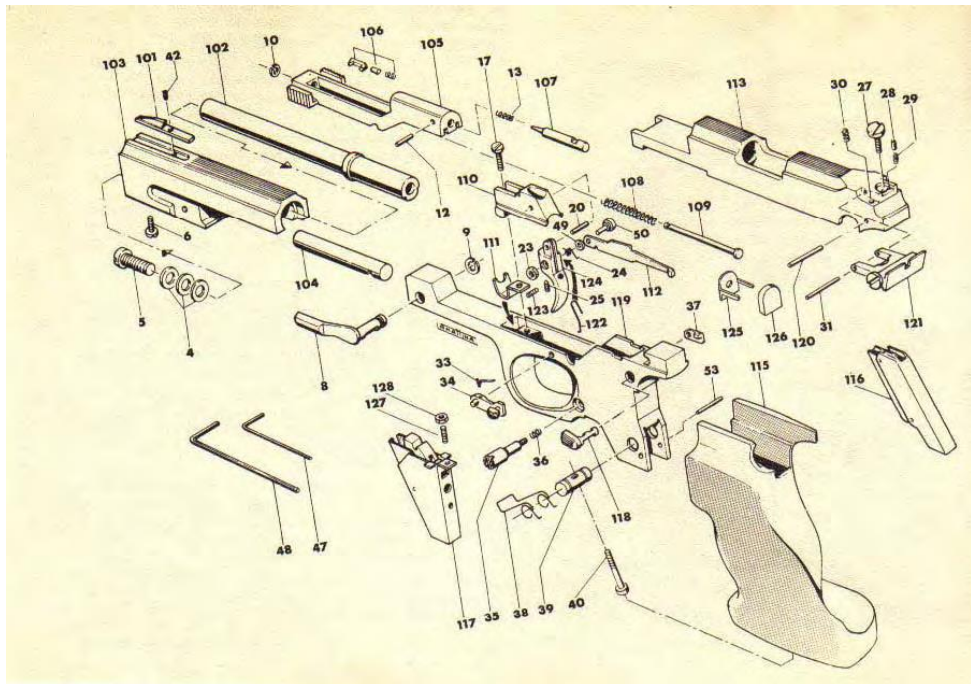

4	Ranelle elastiche	35	Pulsante arresto caricatore	107	Percussore
5	Vite regolazione bloccaggio	36	Molla arresto caricatore	108	Molla carrello
6	Vite fermo spinotto	37	Arresto caricatore	109	Asta guidamolla
8	Chiave bloccaggio	38	Molla espulsione caricatore	110	Rampa
9	Anello elastico	39	Perno fissaggio impugnatura	111	Ammortizzatore elastico
10	Anello elastico	40	Vite fissaggio impugnatura	112	Disconnettore
12	Spina	42	Vite fissaggio mirino	113	Copricarrello
13	Molla del percussore	47	Chiave mirino e regolazione grilletto	115	Impugnatura
17	Vite fissaggio rampa	48	Chiave per impugnatura	115A	Impugnatura per mancino
20	Perno grilletto	49	Ranella	116	Caricatore
23	Dado fissaggio disconnettore	50	Perno disconnettore	117	Scatto 700-800/300-200
24	Molla disconnettore	53	Spina elastica	118	Sicura
25	Vite regolazione precorsa grilletto	101	Mirino mm 3,50	119	Cassa
27	Vite regolazione tacca di mira	101A	Mirino mm 4,00	120	Spina
28	Perno ch'ck	102	Canna	121	Tacca di mira mm 3,00
29	Molla ch'ck	103	Contrappeso	121A	Tacca di mira mm 3,20
30	Molla alzo tacca di mira	103A	Contrappeso Match	122	Molla grilletto
31	Spina elastica	104	Spinotto bloccaggio	123	Vite regolazione grilletto
33	Molla fermo carrello	105	Carrello	124	Grilletto
34	Fermo carrello	106	Estrattore completo	125	Contentore
				126	Ammortizzatore posteriore
				127	Prigioniero
				128	Dado fissaggio scatto



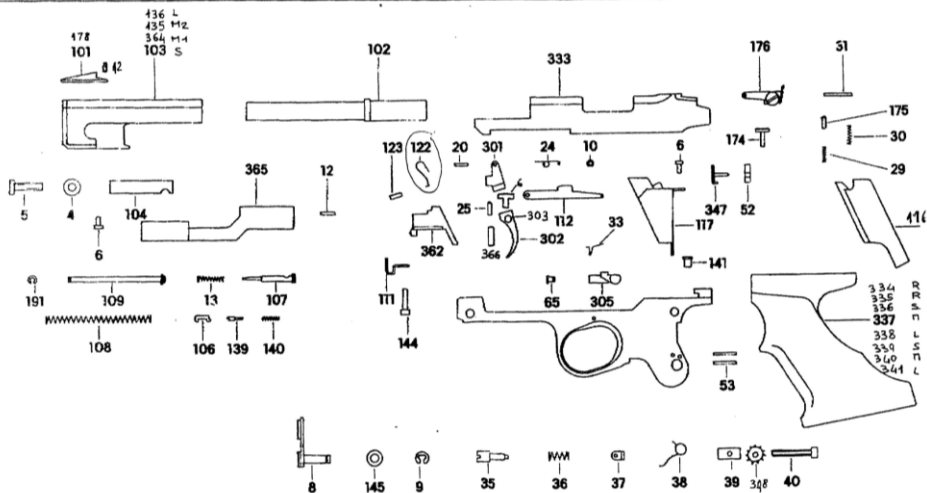

SP 602 cal. 22 l.r.

Mod. 602.B - S.A.P.

