

# **Benelli .22 cal Problems/Questions & Solutions/Answers**

## **Feeding**

**Problem:** I'm having feeding problems.

**Solution:** Have you cleaned your chamber?

If yes, have you done it correctly and thoroughly? 9 out of 10 feeding problems can be remedied by cleaning your chamber. When cleaning your chamber, use a **.25 caliber** brush bent in the shape of an L. Twist the brush to clean. Next, spray Brake-free oil on your patch and pull it through barrel. When the chamber is clean, you should be able to remove the slide, stand the pistol up on end and drop a round into the chamber. If the round has to be pushed into the chamber, continue cleaning and/or send your pistol in for service.

**Solution:** Have you tried different ammunition?

We recommend 40 grain, standard velocity, round nose ammunition. A round with a truncated nose can create feeding problems. **We have found that European ammo is more consistent.** Suggestions: SK, Wolff, Eley, Lapua, RWS

**Solution:** Is your firing pin broken? A broken firing pin may continue to fire cartridges, but occasionally prevent feeding.

**Solution:** Is your buffer cracked, broken or missing? Part #065P new number LGI065P If the buffer appears "beat up" change the recoil spring at the same time. Part # 049P.

## **Firing**

**Problem:** My gun is misfiring; I hear a click.

**Solution:** Have you cleaned your chamber?

If yes, have you done it correctly and thoroughly? 9 out of 10 firing problems can be remedied by cleaning your chamber. When cleaning your chamber, use a .25 caliber brush bent in the shape of an L. Twist the brush to clean. Next, spray Brake-free oil on your patch and pull it through barrel. When the chamber is clean, you should be able to remove the slide, stand the pistol up on end and drop a round into the chamber. If the round has to be pushed into the chamber, continue cleaning and/or send your pistol in for service.

**Solution:** Is the firing pin denting the case when the hammer falls?

If yes, are you getting light or heavy hits?

If the case dents are heavy, odds are your problem is with the ammunition. You should try a few different brands/lots. We have found that **European ammo is more consistent.** Suggestions: SK, Wolff, Eley, Lapua, RWS

If the case dents are light, odds are your chamber may be in some way too tight for your ammunition. If you are sure your chamber is clean, try different ammunition.

**Problem:** My gun is failing to fire; I don't hear a click.

**Solution:** If the pistol is going into battery, but won't fire, send your trigger unit for inspection.

**Problem: My gun is double-firing; I pull the trigger once and get more than one shot.**

**Solution:** Have you cleaned your chamber?

If yes, have you done it correctly and thoroughly? 9 out of 10 firing problems can be remedied by cleaning your chamber. When cleaning your chamber, use a .25 caliber brush bent in the shape of an L. Twist the brush to clean. Next, spray Break-free oil on your patch and pull it through barrel. When the chamber is clean, you should be able to remove the slide, stand the pistol up on end and drop a round into the chamber. If the round has to be pushed into the chamber, continue cleaning and/or send your pistol in for service.

**Solution:** Have you tried different ammunition?

We recommend 40 grain, standard velocity, round nose ammunition. A round with a truncated nose can create feeding problems. We have found that European ammo is more consistent. Suggestions: SK, Wolff, Eley, Lapua, RWS

**Solution:** Is your firing pin broken? Check fired cases for firing pin strikes. If you have fired cases with no indent from the firing pin. If the pistol is slam-firing discontinue use and send you pistol for service

## Ejecting

**Problem: I'm having ejecting problems.**

**Solution:** Have you checked your extractor for damage? If in doubt, send in the bolt for inspection.

**Solution:** Have you cleaned your chamber?

If yes, have you done it correctly and thoroughly? 9 out of 10 ejecting problems can be remedied by cleaning your chamber. When cleaning your chamber, use a .25 caliber brush bent in the shape of an L. Twist the brush to clean. Next, spray Brake-free oil on your patch and pull it through barrel. When the chamber is clean, you should be able to remove the slide, stand the pistol up on end and drop a round into the chamber. If the round has to be pushed into the chamber, continue cleaning and/or send your pistol in for service.

**Solution:** Is your ammunition strong enough to cycle the slide?

We recommend 40 grain, standard velocity, round nose ammunition. We have found that European ammo is more consistent. Suggestions: SK, Wolff, Eley, Lapua, RWS

**Solution:** Check buffer and recoil spring for wear.

## Accuracy

**Problem: I'm having accuracy problems; my shots are rarely/sometimes/always all over the place.**

**Solution:** Have you cleaned your chamber?

If yes, have you done it correctly and thoroughly? When cleaning your chamber, use a .25 caliber brush bent in the shape of an L. Twist the brush to clean. Next, spray Brake-free oil on your patch and pull it through barrel. When the chamber is clean, you should be able to remove the slide, stand it up on end and drop a round into the chamber. If the round has to be pushed into the chamber, continue cleaning and/or send your pistol in for service.

**Solution:** Is there lead buildup in the barrel?

If yes, clean your barrel. Lead buildup, or leading, can tear up your bullets. This can cause them to slow down and want to move sideways. After cleaning your chamber, you should clean your barrel with bore solvent, brush and a patch. Only use a brush in your barrel to remove lead buildup. Don't forget to inspect the muzzle crown for build up. #00 steel wool is good for cleaning the crown.

**Solution:** Have you tried different ammunition?

We recommend 40 grain, standard velocity, round nose ammunition. We have found that European ammo is more consistent. Suggestions: SK, Wolff, Eley, Lapua, RWS

## **Trigger**

**Question:** Can I shorten my trigger pull, the length of travel from slack to over-travel?

**Answer:** No. If you have the MP95 you can adjust the amount of slack and first stage weight. If you have the MP90, you can adjust for over travel, second stage weight and trigger tongue position.

**Question:** How light can I get my trigger?

**Answer:** The lightest we will set your trigger is 2lbs. Both the standard and adjustable triggers will go as heavy as 3 ½lbs.

If you are still having issues with your pistol and need to send it in for repair, we ask that it is accompanied by a note regarding the problem with a good daytime phone to reach you at, shipped in a hard case, and include your magazines. Please allow 6 to 8 weeks for all repairs:

**DO NOT USE POSTAL SERVICE.**

**DO NOT SHIP AMMO IN THE SAME PACKAGE AS THE PISTOL.**  
**IT IS GOOD TO SEND YOUR MAGAZINES WITH THE PISTOL.**

Shipping address for Larry's Guns:

**LGI  
56 WEST GRAY RD  
GRAY, ME 04039**

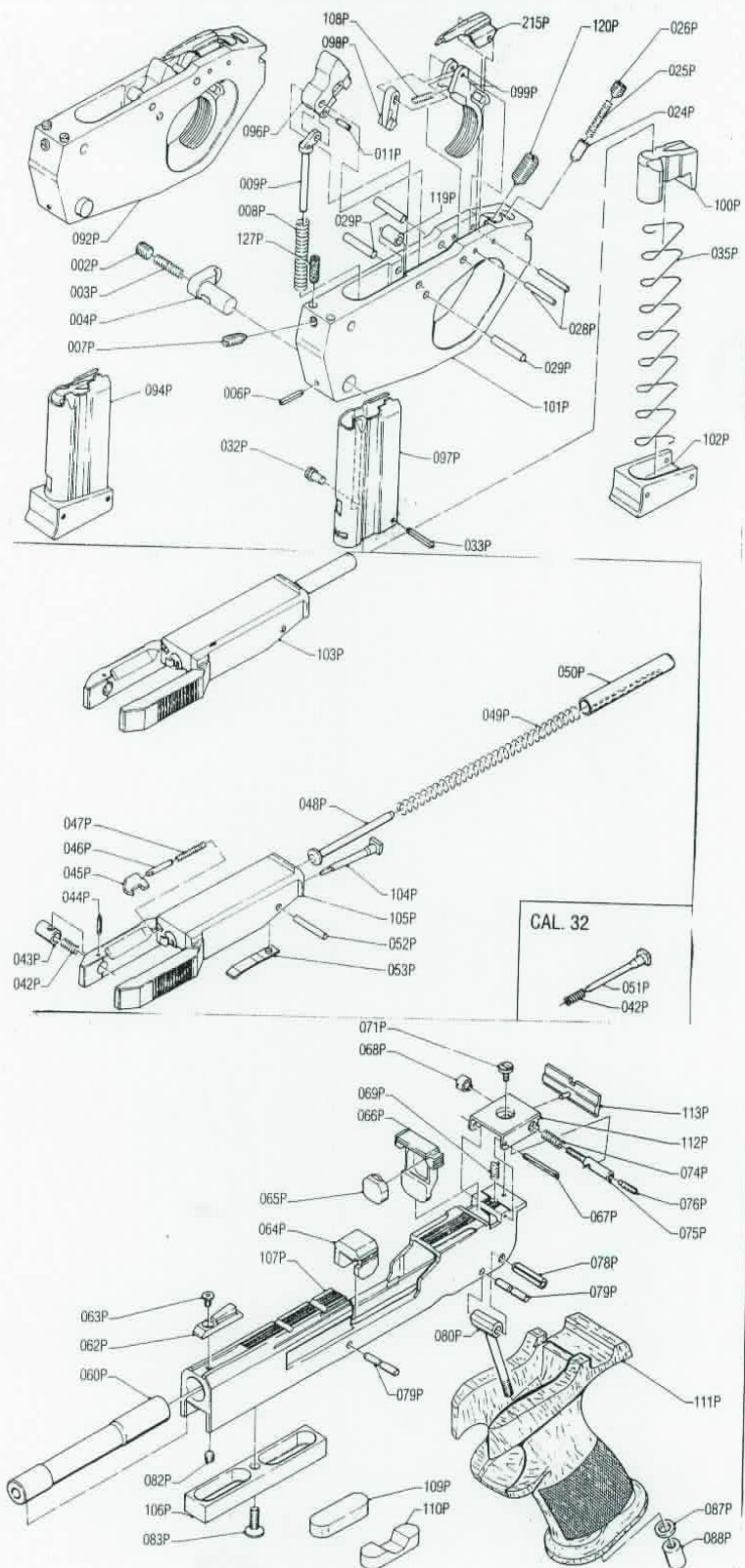

Item	Description	Price
BENELLI PARTS	BENELLI PARTS	0.00
BENELLI PARTS:001P-F0038201	TRIGGER GROUP, MP90S	417.00
BENELLI PARTS:002P-90005000	SET SC/CLIP BUTTON TRAY 54	2.52
BENELLI PARTS:003P-G0032500	CLIP BUTTON SPRING TRAY 54	5.00
BENELLI PARTS:004P-G0040800	GRIP IN/MGZ/BL/MP TRAY 54	34.65
BENELLI PARTS:005P-G0039300	TRIGGER GUARD W/O SAFETY CATCH	270.90
BENELLI PARTS:006P-60333	SPIROL PIN TRAY 54	3.18
BENELLI PARTS:007P-90006200	SPRING GRUB MP TRAY 54	9.66
BENELLI PARTS:008P-G0039800	SPRING/MP90S/HMM TRAY 54	5.00
BENELLI PARTS:009P-G0039601	GUIDE PIN/SPR/HMM/NS/MP TRAY 54	5.00
BENELLI PARTS:011P-90003400	HAMMER SPRING GUIDE MP TRAY 54	2.52
BENELLI PARTS:014P-G0041902	Trigger SUPPORT TRAY 54	37.59
BENELLI PARTS:015P-G0050200	TRIGGER/MP90S 7 MM WIDTH MP90 S &WC TRAY 54	34.23
BENELLI PARTS:016P-90002300	SCREW/TGG STOP TRAY 54	2.52
BENELLI PARTS:017P-90002600	ELASTIC PIN/HMM STOP TRAY 54	2.52
BENELLI PARTS:018P-G0039900	PIN/ADJ/CAM/MP90S TRAY 54	2.52
BENELLI PARTS:019P-90005700	PIN FASTENING GRUB SCREW TRAY 54	2.52
BENELLI PARTS:020P-90005500	SECOND STAGE ADJ. SCREW TRAY 54	2.52
BENELLI PARTS:021P-G0040300	2nd STAGE ADJ. SCREW BUSH TRAY 54..	9.45
BENELLI PARTS:022P-G0040400	2nd PULL ADJ. PLUNGER TRAY 54	6.72
BENELLI PARTS:023P-G0040500	2nd STAGE SPRING TRAY 54	5.00
BENELLI PARTS:024P-G0040600	PIN/1ST ADJ/BL/MP TRAY 54	7.14
BENELLI PARTS:025P-G0040700	SPRING (025P) TRAY 54	5.00
BENELLI PARTS:026P-90004900	1st ADJUSTMENT GRUB SCREW TRAY 54..	2.52
BENELLI PARTS:027P-90005100	SET SC/RR HMM STOP TRAY 54	2.52
BENELLI PARTS:028P-90002500	PIN/DSC/TRIG TRAY 54	3.36
BENELLI PARTS:029P-90002400	PIN/HMM TRAY 54	3.36
BENELLI PARTS:032P-G0041800	BUTTON/CTD PR/MP90S TRAY 55	6.93
BENELLI PARTS:033P-90003100	MOUNTING PIN TTRAY 54	2.52
BENELLI PARTS:035P-G0041100	SPRING/MP90S/22/LR/MGZ TRAY 55	6.00
BENELLI PARTS:035P-G0041600	SPRING/MP90S/32/WC/MGZ TRAY 55	6.00
BENELLI PARTS:035P-G0078300	LOADER SPRING FOR 9-SHOT MAG	6.00
BENELLI PARTS:042P-G0043401	SPRING 22LR TRAY 55	5.00
BENELLI PARTS:042P-G0044000	SPRING/MP90S/32/WC TRAY 55	5.00
BENELLI PARTS:043P-G0043300	GRIP/PIN/BOLT/BL/MP95 22LR TRAY 55	8.82
BENELLI PARTS:043P-G0043900	GRIP PIN/BOLT/CH/MP22LR TRAY 55	8.82
BENELLI PARTS:043P-G0066700	MP90S, MP90 WC AND MP95 32 CAL. TRAY 55	8.82
BENELLI PARTS:044P-90003700	ELASTIC PIN/BOLT STOP TRAY 55	2.52
BENELLI PARTS:045P-G0066901	EXTRACTOR/NCK/MP22LR TRAY 55..	16.00
BENELLI PARTS:045P-G0080301	EXTRACTOR/NCK/MP32WC TRAY 55..	13.02
BENELLI PARTS:046P-G0066801	GRIP PIN/EXTR/NCK/MP TRAY 55	11.60
BENELLI PARTS:047P-G0043000	SPRING/MP90S/EXTR TRAY 55	7.20
BENELLI PARTS:048P-G0042900	GUIDE PIN/SPR/RCV/MP90S TRAY 55 TRAY 59..	6.30
BENELLI PARTS:049P-G0042800	SPRING/MP90S/22/LR/BOLT RET/FI TRAY 55 &56	5.30
BENELLI PARTS:049P-G0043700	RECOIL SPRING TRAY 55	5.30
BENELLI PARTS:050P-G0042700	BUSH/SPR/RCV/MP90S TRAY 55	14.07
BENELLI PARTS:051P-G0043600	FIRING PIN, MP90/32 CAL TRAY 55	11.65
BENELLI PARTS:052P-90004100	ELASTIC PIN/FIRE PIN TRAY 56	2.52
BENELLI PARTS:052P-90008000	PIN/FIRING PIN/BL/MP TRAY 56	2.52
BENELLI PARTS:053P-G0042600	Plate/Firing Pin/BL/MP TRAY 56	11.76
BENELLI PARTS:053P-G0060644	F.P. RETAINING PLATE	11.76
BENELLI PARTS:060P-G0044800	PISTOL BARREL/MP90S/32/WC	141.54
BENELLI PARTS:060P-G0060657	PISTOL BARREL/BL/MP22LR	141.54
BENELLI PARTS:062P-G0044601	FRONT SIGHT/BL/MP TRAY 56	20.00
BENELLI PARTS:062Z	KITE FRONT SIGHT	20.00

BENELLI PARTS:063P-90002000	FRONT SIGHT FASTENING TRAY 56	2.52
BENELLI PARTS:064P-G0093900	OPEN CHAMBER INDICATOR, 22..G0093900 TRAY 56	18.00
BENELLI PARTS:064P-G0094000	OPEN CHAMBER INDICATOR, 32 TRAY 56..	18.00
BENELLI PARTS:065P-G0045001	BOLT RECOIL DAMPER TRAY 56	14.63
BENELLI PARTS:066P-G0044900	BOLT LOCKING SUPPORT BLUED TRAY 57	19.53
BENELLI PARTS:066P-G0067700	BOLT LOCKING SUPPORT CHROME MP95 TRAY 57	19.53
BENELLI PARTS:067P-90004200	PIN FOR REAR SIGHT SUPPORT TRAY 56	2.12
BENELLI PARTS:068P-G0045300	SCREW/ADJ/LTR/BL/MP TRAY56	5.25
BENELLI PARTS:068P-G0068000	SCREW/ADJ/LTR/CH/MP95E TRAY 56	5.25
BENELLI PARTS:069P-G0045902	SPRING/MP/SGH HGT ADJ TRAY 56	5.00
BENELLI PARTS:071P-G0045100	SCREW/ADJ/HGT/BL/MP TRAY 56	5.25
BENELLI PARTS:071P-G0068100	SCREW/ADJ/HGT/CH/MP95E TRAY 56	5.25
BENELLI PARTS:074P-G0045201	SPRING/MP90S/SGH LTR ADJ TRAY 56	5.00
BENELLI PARTS:075P-G0045400	PIN/RR SGH/BL/MP TRAY 56	2.52
BENELLI PARTS:075P-G0067900	PIN/RR SGH/CH/MP95E TRAY 56	2.52
BENELLI PARTS:076P-60610	SET SC/REAR SIGHT MP TRAY 56	2.52
BENELLI PARTS:077P-G0045701	PISTOL SHIM TRAY 57	3.36
BENELLI PARTS:078P-90003900	GRIP TIE ROD PIN TRAY 57	2.52
BENELLI PARTS:079P-G0045800	TRIGGER GUARD PIN, BLUED TRAY 57	7.14
BENELLI PARTS:079P-G0066100	TRIGGER GUARD PIN, CHROME-PLATED TRAY 57	2.52
BENELLI PARTS:080P-G0046101	GRIP RETAINING SCREW	2.52
BENELLI PARTS:082P-G0047200	SET SC/FST/BRL/BL/MP TRAY 57	3.99
BENELLI PARTS:083P-90001900	SCREW/BAL WGH TRAY 57..	2.52
BENELLI PARTS:087P-90004400	GRIP WASHER TRAY 57	4.41
BENELLI PARTS:088P-G0046000	GRIP RETAINING NUT TRAY 57	9.03
BENELLI PARTS:089P-G0046400	HAND SUPPORT FIXING PIVOT	5.88
BENELLI PARTS:092P-F0031702	TRIGGER GROUP ASSEMBLY PLASTIC BLACK	214.20
BENELLI PARTS:093P-60617	ASM/TRIG GR/P BLK/MP95E, COMPLETE TRIGGER	186.00
BENELLI PARTS:094P-F0019400	BENELLI 22 MAG, 6 RND, LOC 14	52.00
BENELLI PARTS:094P-F0031301	BENELLI 32 CAL 5 ROUND MAGAZINE	62.00
BENELLI PARTS:094P-F0036300	9 ROUND MAG 22 CAL	62.00
BENELLI PARTS:096P-G0039500	HAMMER/MP90S tray 58	38.22
BENELLI PARTS:096P-G0039501	HAMMER/BL/MP95E TRAY 58	38.22
BENELLI PARTS:097P	MAGAZINE BODY	23.00
BENELLI PARTS:098P-G0042002	DISCONNECTOR/MP90S, WC AND MP95 TRAY 58	36.75
BENELLI PARTS:099P-G0058100	TRIGGER/BL/MP95E TRAY 58	24.78
BENELLI PARTS:099P-G0065500	TRIGGER/CH/MP95E TRAY 58	24.78
BENELLI PARTS:100P-G0041202	CARTRIDGE SUPPORT PISTOL 22 TRAY 58	15.00
BENELLI PARTS:100P-G0041700	CARTRIDGE SUPPPORT 32 CAL TRAY 58	15.00
BENELLI PARTS:101P-G0065301	TRIGGER GUARD PLASTIC BLACK	14.91
BENELLI PARTS:102P-G0041000	CLIP BASE MP90 S 22 CAL TRAY 58	9.00
BENELLI PARTS:102P-G0041400	CLIP BASE 32 CAL	9.00
BENELLI PARTS:102P-G0063200	CLIP BASE PLASTIC 22 CAL MP90S, WC, & MP95	9.00
BENELLI PARTS:103P-60615	ASM/BOLT/BL/MP90S/32/WC	205.59
BENELLI PARTS:103P-F0031900	MP90 WC MP95E BOLT ASS CHROME 22 LR	214.20
BENELLI PARTS:103P-F0032000	MP95E BOLT ASS BLUE 22 LR	214.20
BENELLI PARTS:103P-F0036800	MP95E BOLT ASS BLUE 32 WC	214.20
BENELLI PARTS:103P-F0036900	MP95E,MP90S WC BOLT ASS CHROME 32 LR	426.30
BENELLI PARTS:104P-G0042501	FIRING PIN/MP90S/22/LR TRAY 58	11.65
BENELLI PARTS:105P-G0066500	MP95E BOLT BODY BLUE 22 LR	144.06
BENELLI PARTS:105P-G0066600	BOLT CHROME PLATED CAL 22	151.83
BENELLI PARTS:105P-G0071900	MP90/95E BOLT BODY 32 WC	113.61
BENELLI PARTS:106P-G0044700	BALANCING WEIGHT SUPPORT METAL	46.00
BENELLI PARTS:106P-G0067400	BALANCING WEIGHT SUPT PLASTIC	6.00
BENELLI PARTS:108P-G0064300	DISCONECTOR SPRING MP90 S, WC AND MP95 TRAY 58	5.00
BENELLI PARTS:109P-G0050500	BARREL WEIGHT, 40 GM TRAY 58	20.00

BENELLI PARTS:110P-G0050600	WEIGHT/BAL/25 GRS/PISTOLS TRAY 58..	20.00
BENELLI PARTS:111P-G0068200	GRIP, MP95 WALNUT	106.68
BENELLI PARTS:111P-G0068300	GRIP, MP 95, LAMINATED	122.01
BENELLI PARTS:112P-G0062500	REAR SIGHT SUPPORT	29.19
BENELLI PARTS:112P-G0067800	REAR SIGHT SUPPORT CHROME	29.19
BENELLI PARTS:113P-G0063400	REAR SIGHT/A/MP 3.3MM TRAY 58	34.44
BENELLI PARTS:113P-G0063500	REAR SIGHT/B/PISTOLS 3.7MM TRAY 58	34.44
BENELLI PARTS:113P-G0063600	REAR SIGHT C 4.0MM TRAY 58	34.44
BENELLI PARTS:115P-80151	REAR SIGHT/C/PISTOLS	25.25
BENELLI PARTS:117P-60708	HAND SAFETY FASTENING SCREW TRAY 59	2.00
BENELLI PARTS:119P-G0063100	SPACER PISTOL MP95E TRAY 59	2.52
BENELLI PARTS:120P-90007300	PRESSER TRAY 59	9.66
BENELLI PARTS:121Q-60711	SAFETY CATCH MP95E TRAY 59	8.50
BENELLI PARTS:121Q-60739	SAFETY CATCH TRAY 59	8.50
BENELLI PARTS:122Q-60741	SAFETY PIN TRAY 59	5.00
BENELLI PARTS:123P-60713	BUTTON PISTOL PIST MP TRAY 59	2.00
BENELLI PARTS:125Q-60715	L.H. LEVER PISTOL MP TRAY 59	9.25
BENELLI PARTS:126Q-60716	TRIGGER GUARD (PISTOL) MP95E	41.25
BENELLI PARTS:127P-G0066400	TRIGGER GUARD RUBBER DAMPER TRAY 59	2.52
BENELLI PARTS:129Q-60738	PIN TRAY 59	3.50
BENELLI PARTS:133Q-60740	PIN SPRING TRAY 59	2.75
BENELLI PARTS:134P-F0020301	RIGHT HAND LARGE GRIP FOR MP90	275.10
BENELLI PARTS:134P-F0035900	RH PISTOL GRIIP -SMALL MP90	275.10
BENELLI PARTS:134Z	GRIP LARGE RIGHT HAND KITE	204.58
BENELLI PARTS:135P-F0036000	LH PISTOL GRIP LARGE MP90	291.61
BENELLI PARTS:135P-F0039800	LH PISTOL GRIP SMALL MP 90	291.61
BENELLI PARTS:135Z	GRIP LARGE LEFT HAND KITE	210.94
BENELLI PARTS:215P-G0094300	DISCONNECTOR	32.05
BENELLI PARTS:332P-F0108000	CYLINDER, KITE LONG	147.90
BENELLI PARTS:333P-F0108200	CYLINDER SHORT BLUE	147.90
BENELLI PARTS:341	CYLINDER, KITE SHORT	147.90
BENELLI PARTS:341Z	SEAL, KITE	12.32
BENELLI PARTS:345Z	DRY FIRE DEVICE, KITE	22.26
BENELLI PARTS:374Z	BLEEDER, KITE	10.39
BENELLI PARTS:376Z	KITE FILL ADAPTER	15.90
BENELLI PARTS:90016400	SPRING PRESSOR TRAY 59..	10.00
BENELLI PARTS:9005600	REAR SIGHT SCREWS SET KITE	2.50
BENELLI PARTS:A0174901	SUPERSPORT 28" INT. CHOKE W/RIB	1,283.66
BENELLI PARTS:A0358800	DYNAMIC LIM.ED. 12GA 28" INT. CH. W/RIB	1,300.20
BENELLI PARTS:BENELLI 10836	YOUTH MODEL 20GA #	952.94
BENELLI PARTS:BMAG22-9	BENELLI 9-RND MAG, CAL 22, LOC 14	47.65
BENELLI PARTS:COMPLETE SEAL KIT, KITE	SEAL KIT FOR THE KITE	121.90
BENELLI PARTS:F0019601	BOLT ASS. MP90S CAL. 22	258.96
BENELLI PARTS:F0020500	ADJUSTING WRENCH KIT ASSEMBLY FOR MP MP90 AND MP 95 22 CAL	26.49
BENELLI PARTS:F0020600	ADJUSTING WRENCH KIT FOR 32 CAL	26.49
BENELLI PARTS:F0031502	TRIGGER GROUP MP-95, SECOND GEN.	159.00
BENELLI PARTS:F0095900	PRESSURE GAUGE ASS. KITE	45.58
BENELLI PARTS:F0096700	BLACK LONG CYLINDER, KITE	147.90
BENELLI PARTS:F0096800	KITE AIR CYLINDER MED. BLACK	147.90
BENELLI PARTS:F0096900	KITE AIR CYLINDER SHORT BLACK	147.90
BENELLI PARTS:F0099501	GRIP LARGE RIGHT FOR KITE	210.94
BENELLI PARTS:F0108100	KITE AIR CYLINDER MED. BLUE	147.90
BENELLI PARTS:F0108300	KITE AIR CYLINDER LONG RED	147.90
BENELLI PARTS:F0108400	KITE AIR CYLINDER MED. RED	147.90
BENELLI PARTS:F0108500	KITE AIR CYLINDER SHORT RED	147.90

BENELLI PARTS:F0119400	ELEVATION SCREW, KITE	8.00
BENELLI PARTS:F0122300	KITE AIR CYLINDER UPPER-MED.BLACK	147.90
BENELLI PARTS:F0122400	KITE AIR CYLINDER UPPER-MED.BLUE	147.90
BENELLI PARTS:F0129600	WEIGHTS SET KITE (FOR THE BARREL)	18.00
BENELLI PARTS:FO122500	TRIGGER GUARD WEIGHT, KITE	0.00
BENELLI PARTS:G0046900	TRIGGER ADJUSTING TOOL TRAY 58	3.78
BENELLI PARTS:G0060656	FRONT SIGHT 4.0MM	20.00
BENELLI PARTS:G0194601	CYLINDER MOUNT, KITEDER MOUNT, KITE	45.00
BENELLI PARTS:G0195101	FRONT SIGHT 5MM TRAY 59	29.68
BENELLI PARTS:G0195301	FRONT SIGHT 4MM TRAY 59	29.68
BENELLI PARTS:G0195800	KITE FILL ADAPTERO RING, (90017700) TRAY 60 TRAY	5.00
BENELLI PARTS:G0196200	VALVE SEAL FOR KITE	5.00
BENELLI PARTS:G0198400	DRY FIRE LEVER TRAY 59	15.90
BENELLI PARTS:G060642	EMPTY CHAMBER INDICATOR	7.84
BENELLI PARTS:G1098400	FIRING PIN LEVER KITE	5.00
BENELLI PARTS:G40040700	1st PULL ADJUSTMENT PIN SPRING	5.00
BENELLI PARTS:KITE GRIP Left, LG	Left Large Grip for KITE	210.94
BENELLI PARTS:KITE GRIP RH	RH grip for Kite	210.94
BENELLI PARTS:KITE GRIP, Small, LH	Small LH Grip for Kite	210.94
BENELLI PARTS:V903004	WASHER FOR A MODEL B80	7.80
BENELLI PARTS:VPG11291	GUIDE ROD, B 80	13.80
BENELLI PARTS:VPG11762	FIRING PIN FOR B76	24.38
BENELLI PARTS:VPG21347	HAMMER	71.02
BENELLI PARTS:VPG21348	SEAR	47.70
BENELLI PARTS:VPG31037	SPRING	12.00
BENELLI PARTS:VPG31855	LH CUSTOM FIT GRIP	127.20
BENELLI PARTS:VPG31856	RH CUSTOM FIT GRIP	127.20